

# Fact Sheet: nbn™ Fixed Wireless connections

## What is Fixed Wireless?

The **nbn™** Fixed Wireless network uses advanced technology commonly referred to as LTE or 4G, and is engineered to deliver services to a fixed number of premises within each coverage area.

This means that the bandwidth per household is designed to be more consistent than mobile wireless, even in peak times of use. Unlike a mobile wireless service where speeds can be affected by the number of people moving into and out of the area, the speed available in a Fixed Wireless network is designed to remain relatively steady.

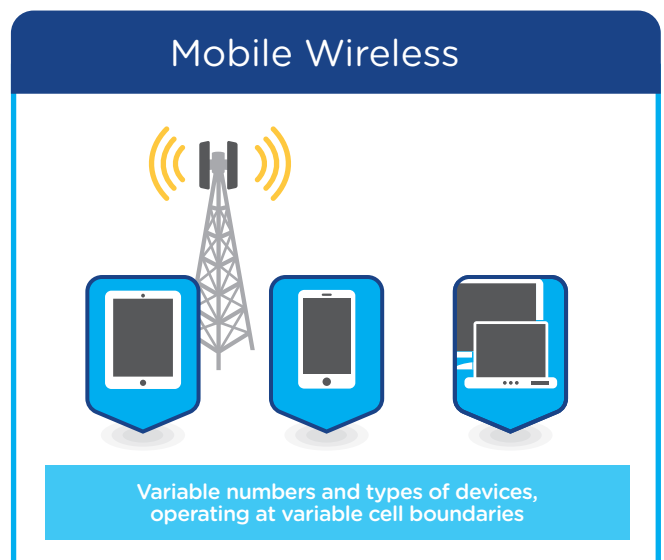
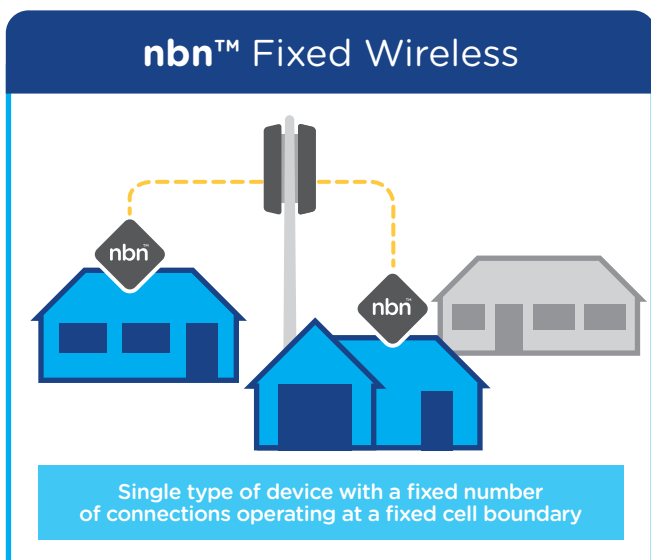

## What is the nbn™ network?

The **nbn™** network is Australia's new landline phone and internet network. It's designed to provide you with access to all the benefits of fast and reliable internet services, no matter where you live.

To make sure everyone has the chance to access fast and reliable landline phone and internet services as quickly and cost effectively as possible, the **nbn™** network is being rolled out using a mix of technologies that are best suited to your area.

The **nbn™** network is so much more than fast internet. A state of the art communications network opens up a world of possibilities across areas such as education, business and entertainment, and gives Australians the opportunity to be more productive, more creative, more efficient and more connected for decades to come.

As a wholesaler, **nbn** does not sell direct to the public. That means, to move your services over to the **nbn™** network, (both home and business services) you will need to contact a phone or internet provider and choose a new plan that suits your needs directly with them.



Australia's  
broadband  
network  
bring it on

# How does nbn™ Fixed Wireless work?

The nbn™ Fixed Wireless network is designed to offer retail service providers with wholesale access speeds of up to 25Mbps for downloads and 5Mbps for uploads.

While nbn's high-quality Fixed Wireless service is not a mobile service, it will use cellular technology to transmit signals to and from a small antenna fixed on the outside of a home or business, which is pointed directly towards the nbn™ Fixed Wireless facility. nbn has designed each facility to serve a set number of premises, which enables greater consistency in the speed and quality of service that can be delivered to each home and business receiving the nbn™ Fixed Wireless service. The actual speed and quality of the service experienced by end users will depend on some factors outside nbn's control including equipment quality, software, plans offered by service providers and how their service provider designs its network.

## Building the nbn™ Fixed Wireless network

In order to provide access to fast, affordable and reliable internet, nbn works in consultation with local, state and federal governments to determine the most efficient and effective way to roll out the Fixed Wireless network. A key consideration in these decisions is the optimal network design. The nbn™ network engineers take into account factors such as population density, geography and other network specific considerations when defining rollout plans.

The Fixed Wireless rollout is now well underway, with many regions already live and receiving services. nbn's priority is to use existing telecommunications structures wherever possible. Where there is a lack of suitable, available infrastructure, nbn will seek to establish new sites to facilitate the delivery of consistent, high quality broadband. This generally involves lodging a development application with the relevant authority and engaging with the local community

## nbn™ Fixed Wireless at your place

Our Fixed Wireless services are delivered by radio communications from an nbn™ Fixed Wireless facility direct to a small outdoor antenna attached to the premises.

The antenna on the outside of a home or business will be connected by a cable running through the wall to the nbn™ connection box which will be located within your home or business. Generally, your phone or internet service provider will assist you with the best means of

connecting your computer, TV or Wi-Fi router to the nbn™ supplied connection box. That device sits within the building, and is hardwired to the nbn™ outdoor antenna pointed at an nbn™ Fixed Wireless facility.

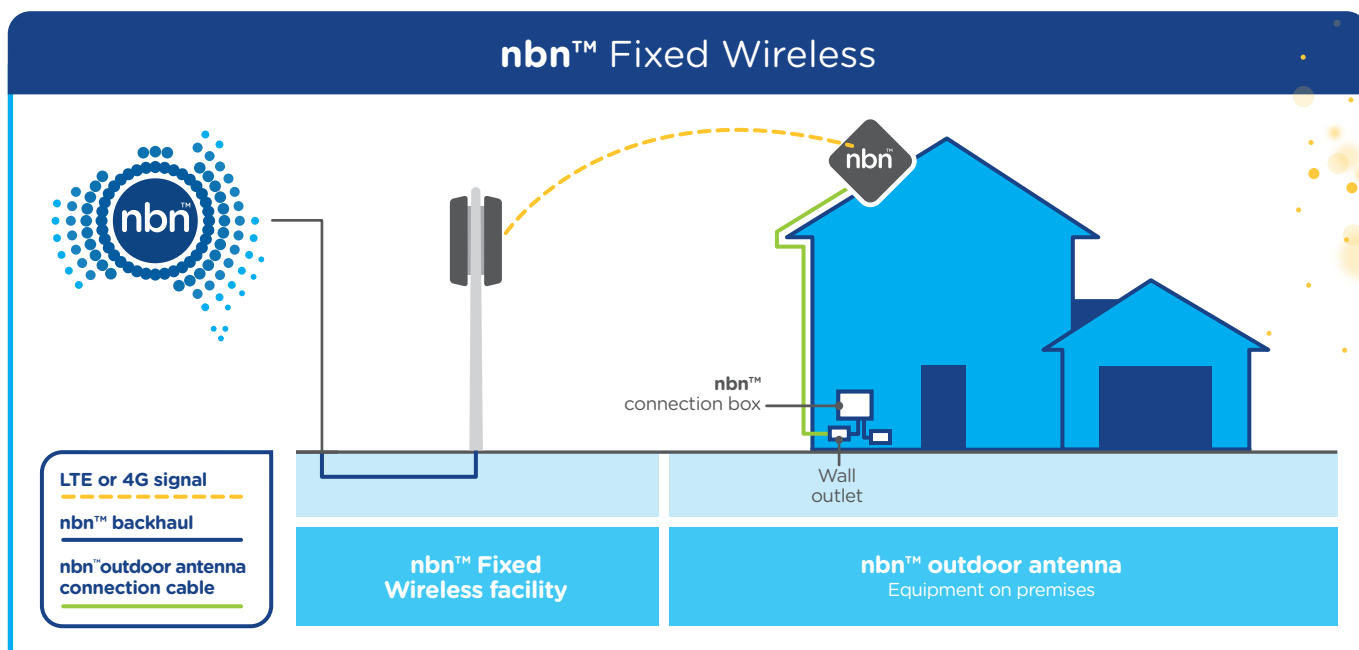

# What does **nbn**<sup>™</sup> Fixed Wireless equipment look like?

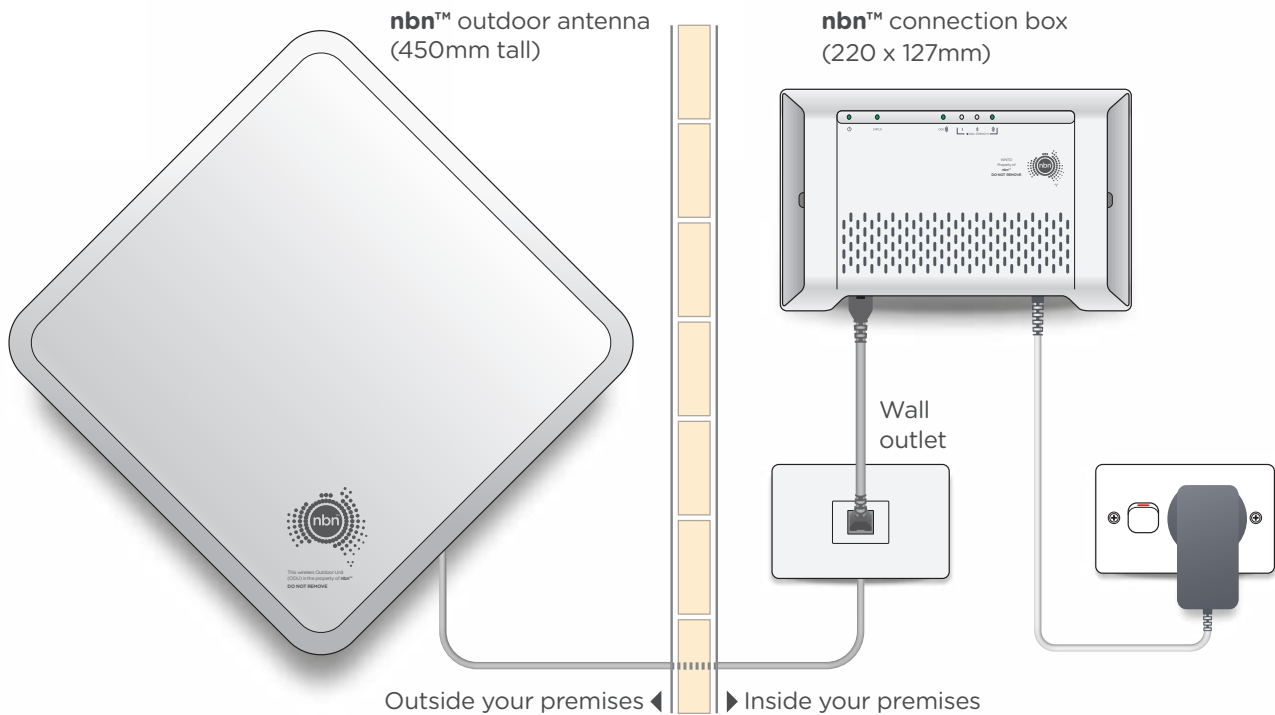

## Getting connected

**nbn** is a wholesale provider, which means that once Fixed Wireless becomes available in your area, you will need to contact your preferred service provider to order a service. Although your copper phone line will remain in place, your service provider may offer voice over broadband products as an alternative to landline telephone services.

Before the network equipment is installed, a service validation test will be carried out. If your home or business is unable to be served by **nbn**<sup>™</sup> Fixed Wireless or other fixed line technologies, you will likely be able to receive **nbn**'s Long Term Satellite service which is scheduled for launch in 2016. In the meantime there may be a number of other options available including mobile

internet and commercial satellite. We recommend that you speak to your preferred phone or internet provider to discuss your options.

Once the validation test has been confirmed, your service provider will organise the installation of **nbn**<sup>™</sup> supplied equipment at your premises. A standard installation of **nbn**<sup>™</sup> supplied equipment is currently free of charge. Remember to ask your preferred provider if they have any other fees. For more information about standard and non-standard installations please visit [nbn.com.au](http://nbn.com.au)

### To switch to the **nbn**<sup>™</sup> network:

- Call your preferred phone or internet provider
- Choose a package that suits your needs

For a full list of service providers visit [www.nbn.com.au/serviceproviders](http://www.nbn.com.au/serviceproviders)



Australia's  
broadband  
network  
bring it on

## For more information

call **1800 687 626** | visit [nbn.com.au](http://nbn.com.au) | [info@nbn.com.au](mailto:info@nbn.com.au)

If you want to connect to the **nbn™** network you will need to speak to a phone or internet provider. Maps showing the current rollout plans for the **nbn™** Fibre and **nbn™** Fixed Wireless services areas, as well as further information about the **nbn™** network rollout are available at [nbn.com.au](http://nbn.com.au)